

# architect's toolbox

**STIIMA**

# architect's toolbox

## 2025

### **PUBLISHER**

OTIIMA

### **EDITORS**

JOANNA HELM  
DIANA MAGALHÃES

### **DESIGN EDITOR**

SUSANA SOUSA

### **PHOTOGRAPHY**

MARIA JOÃO SOARES  
BRUNO LANÇA  
FERNANDO GUERRA | FG + SG  
AMIT GERON  
JOE FLETCHER  
TIM VAN DE VELDE  
JURE ŽIVKOVIĆ  
NUDO  
TOMEU CANYELLAS  
JOÃO REY SOARES  
JOÃO FERRAND  
HERVÉ ABBADIE  
STÉPHANE ABOUDARAM | WE ARE CONTENTS

### **IMAGES**

ALAIN SOSA  
LEONARDO PIZARRO  
RAUL RABRE

### **DATE AND VOLUME**

02/01/2025  
1000 UNITS

### **CONTACTS**

[www.otiima.com](http://www.otiima.com)

### **PRINTING AND BINDING**

GRÁFICA MAIADOURO

### **LEGAL DEPOSIT**

541149/24

© architect's toolbox by OTIIMA

Total or partial reproduction of any text or image in this catalogue is strictly prohibited without the publisher's express permission.

## a new vision, a new era

In 2025, OTIIMA begins a new chapter with a refreshed identity that reflects its evolution and commitment to architecture over the past 12 years - one that honors our past while embracing the future.

OTIIMA's philosophy is to drive change through transformation and, when necessary, disruption. This approach helps us solidify a new phase and lay the foundation for a lasting legacy. OTIIMA's renewed identity embodies this belief, blending tradition and modernity. It reflects our commitment to excellence and paves the way for a future where we continue to lead with vision and purpose.

With a legacy deeply rooted in architectural excellence, the visual and identifying impact of the brand was a central focus. The square was reimagined not as a form of enclosure, but as a building block. This approach honors the brand's history and heritage. The square now appears dynamic and versatile, adding solidity and substance while conveying a sense of openness and expansion. The new design reflects an evolution that conveys a message of freedom, creativity and limitless potential in a bold, contemporary style.

The goal is an identity that transcends physical boundaries, positioning itself in a space that transcends fleeting trends and remains relevant and distinct in an ever-changing world.

This new identity is a statement of who we are and where we are going.





# 01. much more than a window

---

the art of transparency **08**

- CAM | Gulbenkian Modern Art Center **13**
- House in Preradoviceva **18**
- Caniçada House **22**

precision in action **26**

- Voluta House **28**
- IS House **32**
- Desert Palisades **36**

designing possibilities **40**

- AL08 House **42**
- The Maybourne Riviera **46**
- Carbon Beach House **50**

# 02. much more than a system

---

otiima plus **58**

otiima vision **62**

otiima fusion **68**

opening typologies **78**

the anatomy of a minimalist window **80**

# 03. much more than a solution

---

motorized sliding system **82**  
motorized guillotine system **83**  
motorized sliding skylight **84**  
motorized pivot system **85**  
otiima pivot **86**  
invisible lock **88**  
meyer lock **89**  
curved glass **90**  
sloped system **91**  
the language of emotion **92**

**table of contents.**



MUCH

WINDOW



A



MORE



architecture AIRES MATEUS project ARCHITECTURE FACULTY OF Tournai images TIM VAN DE VELDE

THAN



arquitectura MÁRIO MARTINS ATELIER project LIBRE HOUSE image FERNANDO GUERRA | FG + SG



## the art of transparency

OTIIMA redefines the connection between design and functionality with a revolutionary approach: integrating cutting-edge solutions into every space, transforming architecture, and unlocking its full potential.

Fusion and the innovative Vision System are at the heart of this evolution. Each system is conceived with a unique approach to seamlessly integrate into architectural contexts, considering aesthetics, design, functionality, form, emotions, human behavior, and the aspirations of the most ambitious projects.

These solutions go beyond their technical purpose; they are tools that reimagine spaces. Clean lines and expansive glass surfaces offer an unparalleled visual and sensory experience: bright and serene interiors that maximize natural light and create a fluid connection with the surroundings.

Much more than functional solutions, OTIIMA designs embody transparency as a fundamental principle — a value that transforms everyday life by bringing clarity, openness, and a deep connection with the landscape. Each window becomes a bridge between the inside and the outside, between people and their experiences, creating spaces that inspire and show us the scenes of everyday life. OTIIMA is fully committed to ensuring that each design meets the highest innovation and safety standards and reflects a deep respect for nature, contemporary design, and functionality.





**CAM | Gulbenkian Modern Art Center**

Kengo Kuma & Associates + OODA + VDLA

**Architect**

Kengo Kuma & Associates + OODA + VDLA

**Year**

2024

**Location**

Lisbon, Portugal

**Typology**

Museum

**Photography**

Fernando Guerra | FG + SG

**System**

Pivot 38 & Plus 38





### **Transition: A dialogue of Architecture and Landscape**

The Modern Art Center (CAM) of the Calouste Gulbenkian Foundation now showcases its renewal, inspired by the Japanese concept of Engawa. This space bridges the interior and exterior as a filter between the building and the garden. This element creates a social environment where visitors can experience outdoor culture uniquely and contemplatively.

The project, led by architect Kengo Kuma, extends the park to the south with an urban forest designed by landscape architect Vladimir Djurovic. This new landscape redefines pathways and connects the garden to the city, unveiling clearings, meadows, rain gardens, and small pavilions that surprise visitors at every turn.

Kuma remarks: "We created a harmonious fusion between architecture and nature. Inspired by the Engawa, this space invites visitors to slow down and connect with their surroundings. Inside the CAM, the same softness is reflected, integrating natural light and the garden with the building."

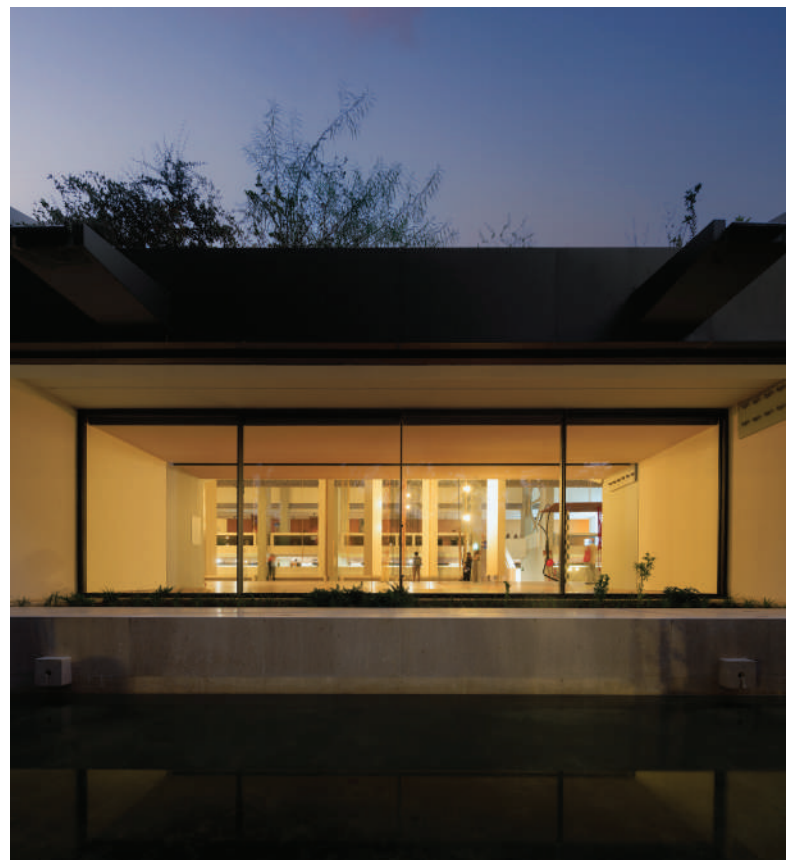







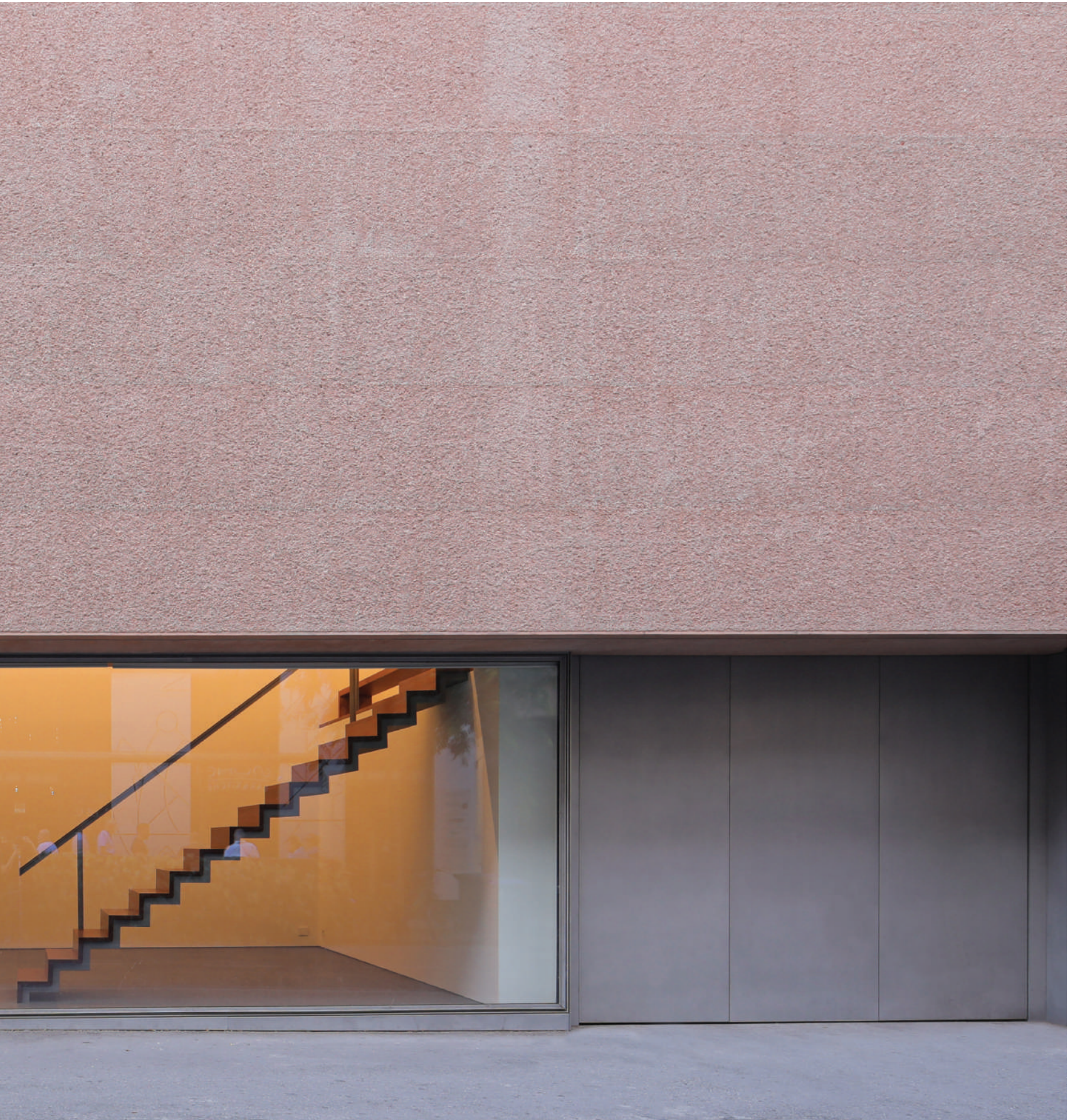

## House in Preradovićeva

Eduardo Souto de Moura + Studio 3HLD

**Architect**

Eduardo Souto de Moura + Studio 3HLD

**Year**

2018

**Location**

Preradovićeva, Croatia

**Typology**

Residential

**Photographs**

Jure Živković

**System**

Plus 38





### **Minimalism and Urban Integration**

Designed by Portuguese architect and Pritzker Prize winner Eduardo Souto de Moura in collaboration with 3LHD studio, Preradovićeva redefines the relationship between urban and private spaces in the heart of Zagreb. The concrete façade, devoid of traditional windows, presents a minimalist expression that balances mystery and functionality.

Known as the “windowless villa,” the building prioritizes the privacy of its residents by creating a visual barrier with the outside. Inside, strategically placed skylights and a central atrium provide abundant natural light, connecting the interiors to the sky and creating a reflective and luminous space.

Preradovićeva exemplifies Souto de Moura’s architectural rigor. Formal simplicity and contextual integration result in a work that balances isolation and interaction, redefining the boundaries of contemporary urban architecture.



WINNER, RESIDENTIAL HOUSE, ARCHITIZER A+AWARDS 2021



## **Caniçada House**

Atelier Carvalho Araújo

**Architect**

Atelier Carvalho Araújo

**Year**

2020

**Location**

Gerês, Portugal

**Typology**

Residential

**Photographs**

NUDO

**System**

Plus 38, Classic 38 & Open 38







### **Architecture in Resonance with Nature**

Designed by the Atelier Carvalho Araújo, Caniçada House transcends the concept of a residence by uniquely integrating architecture and landscape. Perched on a hillside overlooking the Cávado River, the house respects and enhances the topography.

With horizontal lines and a minimalist approach, the residence combines exposed concrete and glass—materials that harmonize with the surrounding landscape and textures, creating a discreet and striking architectural presence.

The spacious interiors seamlessly connect to the exterior through large openings that capture natural light and frame the landscape as an integral part of the space. Terraces and verandas extend this interaction, inviting contemplation.

More than a retreat, Caniçada House is an architectural expression that celebrates the essence of its setting, blending simplicity, elegance, and a profound connection.

## precision in action

OTIIMA represents the perfect integration of interior and exterior through its minimalist window systems, which combine technical precision, functionality, and aesthetics. These solutions meet contemporary demands by merging timeless architectural principles with innovation, creating elegant transitions that enhance light and expand spaces.

Each system is meticulously designed to adapt to the specific needs of every project. Versatile and precise, they offer features such as light control, ventilation, temperature regulation, motorization, custom handles, and tailored options. Through continuous research and innovation, OTIIMA reinvents window design, blending advanced technology with refined finishes that enrich the details of every project. From wide openings that connect spaces to multifunctional configurations, these systems meet diverse requirements with sophistication and excellence.

Driven by a commitment to exclusivity, OTIIMA delivers more than technical solutions—it provides unique experiences. "Much more than a window" is not just a slogan; it promises to exceed expectations, looking at every project as unique, elevating the architectural experience to a new level.





architecture MÁRIO MARTINS ATELIER project VOLUTA HOUSE image FERNANDO GUERRA | FG + SG





## **Voluta House**

Mário Martins Atelier

**Architect**

Mário Martins Atelier

**Year**

2022

**Location**

Algarve, Portugal

**Typology**

Residential

**Photographs**

Fernando Guerra | FG + SG

**System**

Plus 38





### **Architecture in Motion**

The Voluta House project, designed by architect Mário Martins, is inspired by spirals and symbolizes the infinite possibilities of architecture, rising beyond the ordinary to achieve the extraordinary.

More than just a residence, it is a work of art that seamlessly combines functionality and aesthetics through its unique geometry. Its fluid curves create a distinctive interaction, integrating the surrounding landscape as an essential part of the architectural experience through dynamic and engaging spaces.

The design reflects the belief in architecture's transformative power to shape environments and human experiences, enabling the transcendence of traditional boundaries and the exploration of bold forms.







## IS House

Paritzki & Liani

**Architect**  
Paritzki & Liani

**Year**  
2022

**Location**  
Tel Aviv, Israel

**Typology**  
Residential

**Photographs**  
Amit Geron

**System**  
Classic 38





### **Layers of Subtlety and Lightness**

The IS House, designed by architects Paritzki & Liani, is located on a trapezoidal plot with views of an open green area. The house combines modern design with careful integration into the landscape.

With 600 square meters spread across three floors, the central concept was to create an almost invisible structure to the terrain, transforming the local elements into an essential part of the living experience.

One of the most striking aspects is that one end of the house floats above the lower part of the property. This effect was made possible by the difference in terrain height and the large glass surfaces that separate the first floor from the lower level. The carefully folded roof allows the creation of large spans without compromising the stability of the structure.

The IS House is an interpretation of how architecture and landscape can communicate, creating layers that surprise with their delicacy and lightness.

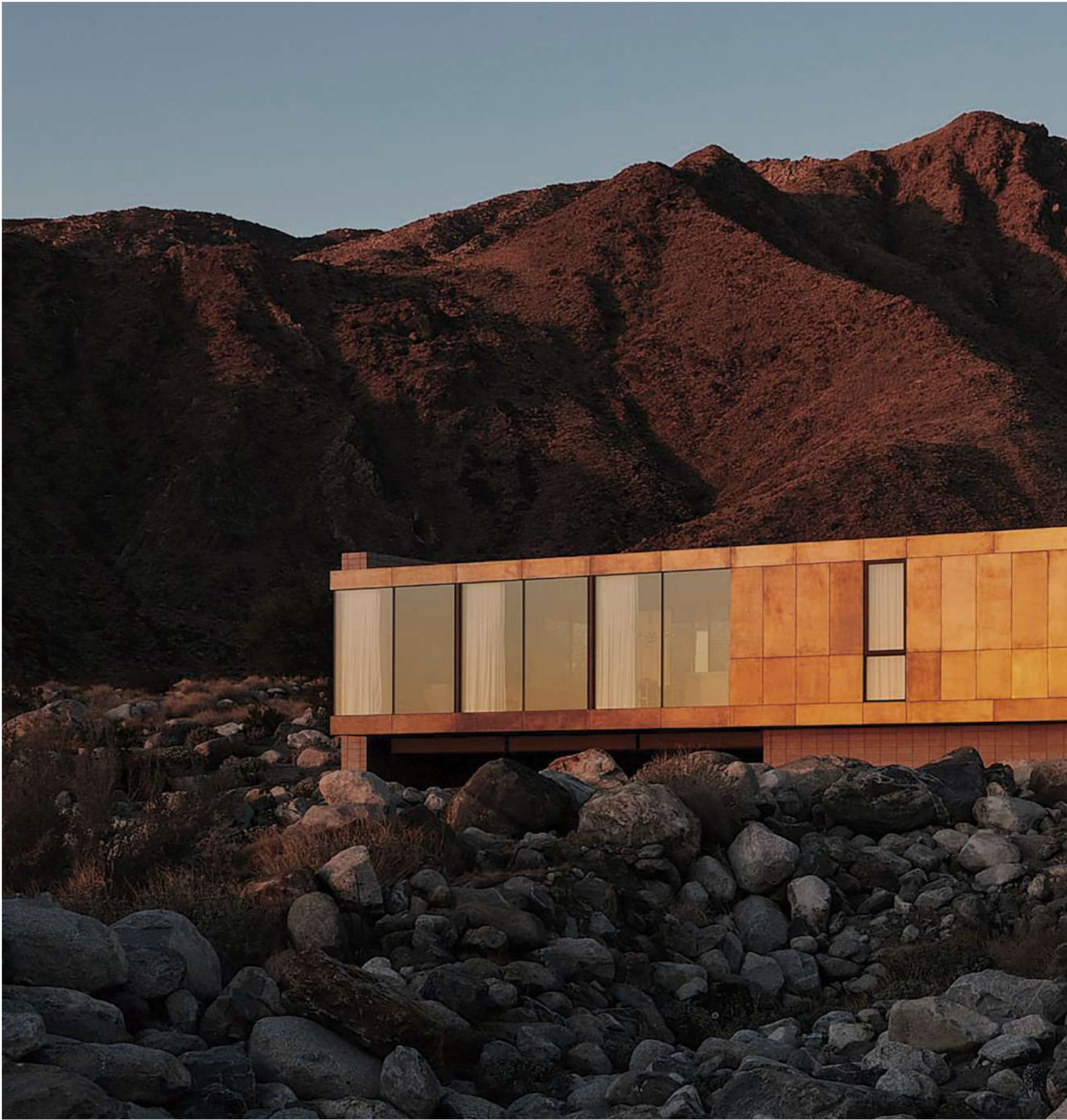

**Wallpaper\***

WINNER, BEST PRIVATE HOUSE, WALLPAPER\* DESIGN AWARDS 2023

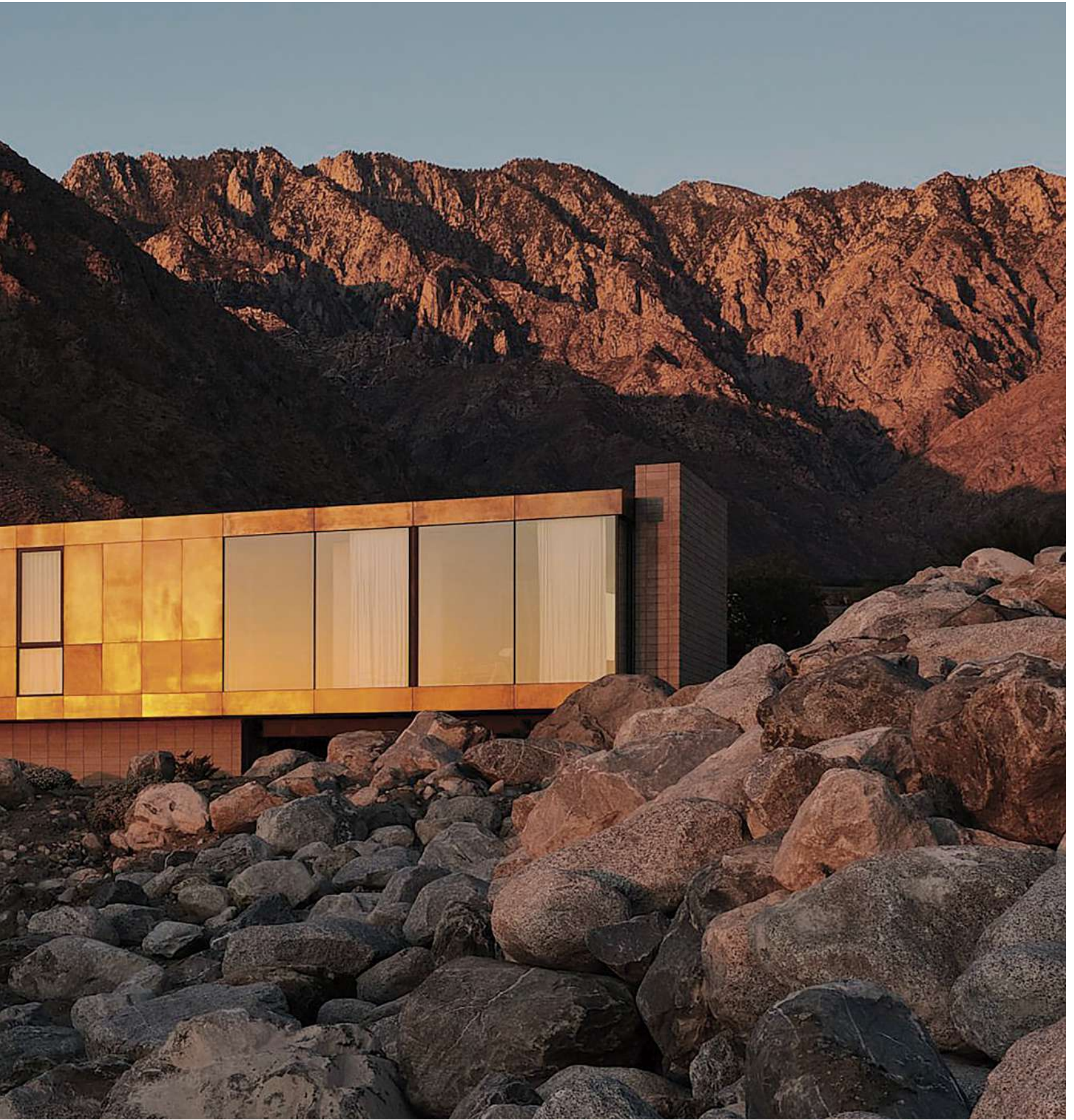

## Desert Palisades

Woods + Dangan

**Architect**

Woods + Dangaran

**Year**

2022

**Location**

Palm Springs, CA, USA

**Typology**

Residential

**Photographs**

Joe Fletcher

**System**

Classic 54





### **Sculpted Architecture in the Desert**

Situated elegantly in the hills above Palm Springs, Desert Palisades by architects Woods + Dangan is a striking embodiment of desert modernism, deeply connected to its arid environment and natural surroundings. Elevated slightly above a site dotted with boulders and spanning a natural arroyo, the home harmonizes with the landscape while maintaining a strong connection to the earth.

The design emphasizes horizontal lines, natural materials, and seamless integration between indoor and outdoor spaces. Earth-toned plaster and textured concrete masonry walls root the slab-on-grade structure to its surroundings, while deep roof overhangs wrapped in brass paneling add a touch of refined modernity.

Strategically placed floor-to-ceiling glazing captures panoramic views of the desert in every direction. A glass-enclosed bridge connects the home's two wings, creating a central atrium visible from almost every room. Expansive sliding glass doors extend the great room outdoors to a deck, pool, spa, fireplace, and lounge, dissolving the boundaries between the built environment and nature.

Desert Palisades is a timeless architectural achievement. Its design honors the principles of mid-century desert modernism while advancing contemporary sophistication.



architecture ESTUDIO CANO project AL08 HOUSE image Tomeu Canyellas





## designing possibilities

From luxury residential to hospitality, from commercial complexes to renovating high-impact cultural buildings, OTIIMA constantly seeks challenges that awaken new architectural possibilities. We aim to establish ourselves as a global reference, driving innovation in architecture and engineering.

The OTIIMA PLUS system balances internal privacy by creating large outdoor spaces protected from the wind and external visibility. In its most visionary form, window frame design inspires unique solutions, such as the FUSION SYSTEM, which introduces an innovative approach to window drainage that is effective even in extreme rain conditions.

With the VISION system, we push the boundaries of design even further, creating unique interaction experiences between the environment and space through transparency.

OTIIMA's passion for minimalist design is expressed in projects that elevate architecture to functional art. The Architect's Toolbook preserves the essence of a minimalist diary, revealing OTIIMA's frame systems—original, unexpected, and sophisticated—that consistently exceed expectations and help shape the future of architecture.

At OTIIMA, each solution is an opportunity to reinvent what is possible.





## AL08 House

Estudio Cano

# Alumilux | ΟΤΙΜΑ

**Architect**  
Estudio Cano

**Year**  
2022

**Location**  
Palma de Mallorca, Spain

**Typology**  
Residential

**Photographs**  
Tomeu Canyellas

**System**  
Fusion 38





### **Architecture as a Response to Context**

The ALO8 House in Palma de Mallorca powerfully illustrates architecture's capacity to respond dynamically to its geographic and environmental context. The residence embodies a dialogue between the solid form of the structure and its natural surroundings, negotiating the dichotomy between solidity and openness and balancing the harshness of a rugged landscape with the advantages of contemporary living. Through meticulous material selection, precise execution, and profound respect for the site, Estudio Cano has created a sanctuary that honors and celebrates its unique environment.





## The Maybourne Riviera

Wilmotte & Associés SAS d'Architecture

**Architect**

Wilmotte & Associés SAS d'Architecture

**Year**

2022

**Location**

Monaco, France

**Typology**

Hospitality

**Photographs**

Stéphane Aboudaram | WE ARE CONTENT(S)

**System**

Fusion 38







### **In Architectural Retreat between sky, sea and mountain**

The Maybourne Riviera, formerly Vista Palace, is a sophisticated and impressive 5-star hotel located in Roquebrune-Cap-Martin, France. It offers breathtaking panoramic views of Monaco and Cap-Martin. Designed by the renowned Agence Wilmotte & Associés Architectes, the hotel's expansion project is committed to preserving the original triangular building, respecting the site's history while seamlessly integrating the architecture and the natural surroundings.

The new design of The Maybourne Riviera adds seven exclusive suites elegantly anchored to the cliffside, providing a unique immersion experience into nature. The architecture complements and merges with the landscape, dissolving the traditional boundaries between indoor and outdoor spaces. This perfect dialogue between structure and environment is accentuated by stunning views of the sky, sea, and mountains, turning each space into a true architectural masterpiece.





## Carbon Beach House

Olson Kundig

**Architect**

Olson Kundig

**Year**

2023

**Location**

Malibu, CA, USA

**Typology**

Residential

**Photographs**

Joe Fletcher

**System**

Classic 38 & Fusion 38





### **Modernity on the Pacific coast**

Located in Malibu along the Pacific Coast Highway, Carbon Beach House, designed by Olson Kundig, frames a responsive oasis oriented toward the sights and sounds of the ocean. The home sits on a custom, self-draining pier elevated above the sand, resilient during high tides and storms while maintaining an easy connection to the waterfront.

A plain, opaque concrete wall forms the property's front elevation, shielding the home from traffic noise from the six-lane highway. A metal entry door creates a break in this solid façade to reveal a glass and steel staircase topped by an expansive skylight, offering views across the width of the home to the water beyond.



MUCH

SYSTEM



A

MORE

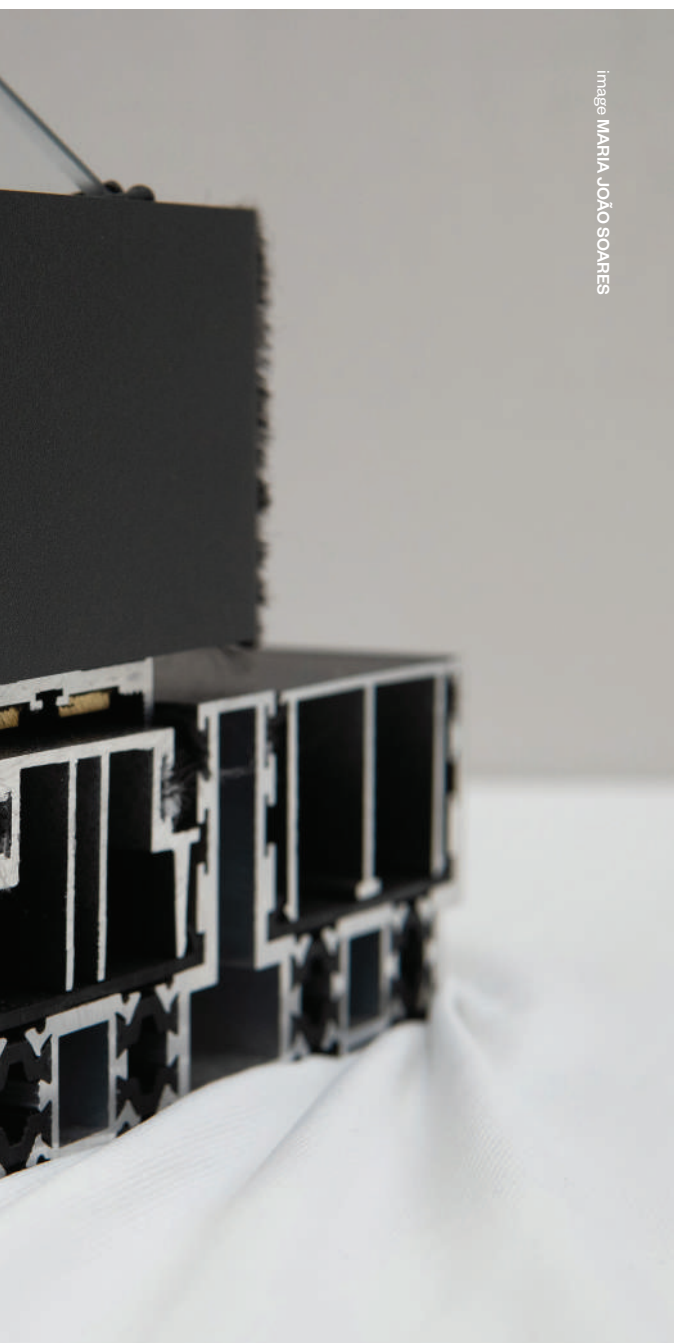

Image: MARIA JOÃO SOARES

THAN

No design is possible until the materials with

- **Ludwig Mies van der Rohe**



which you design are completely understood.

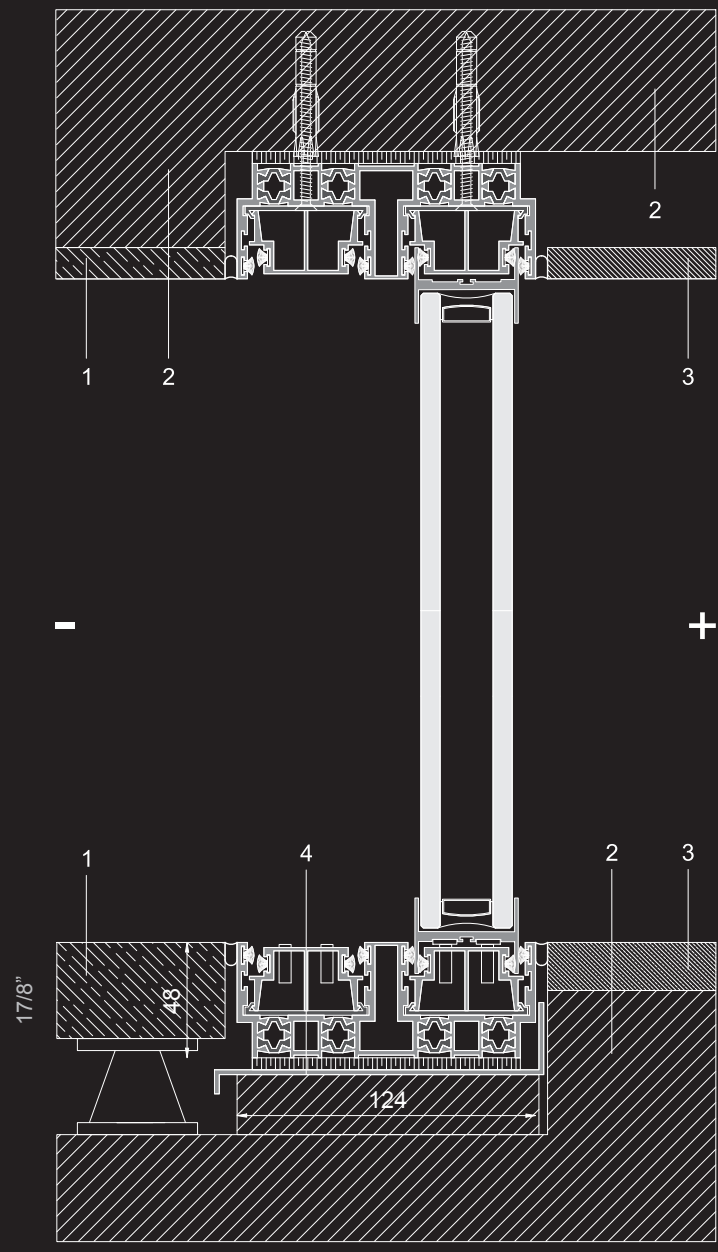
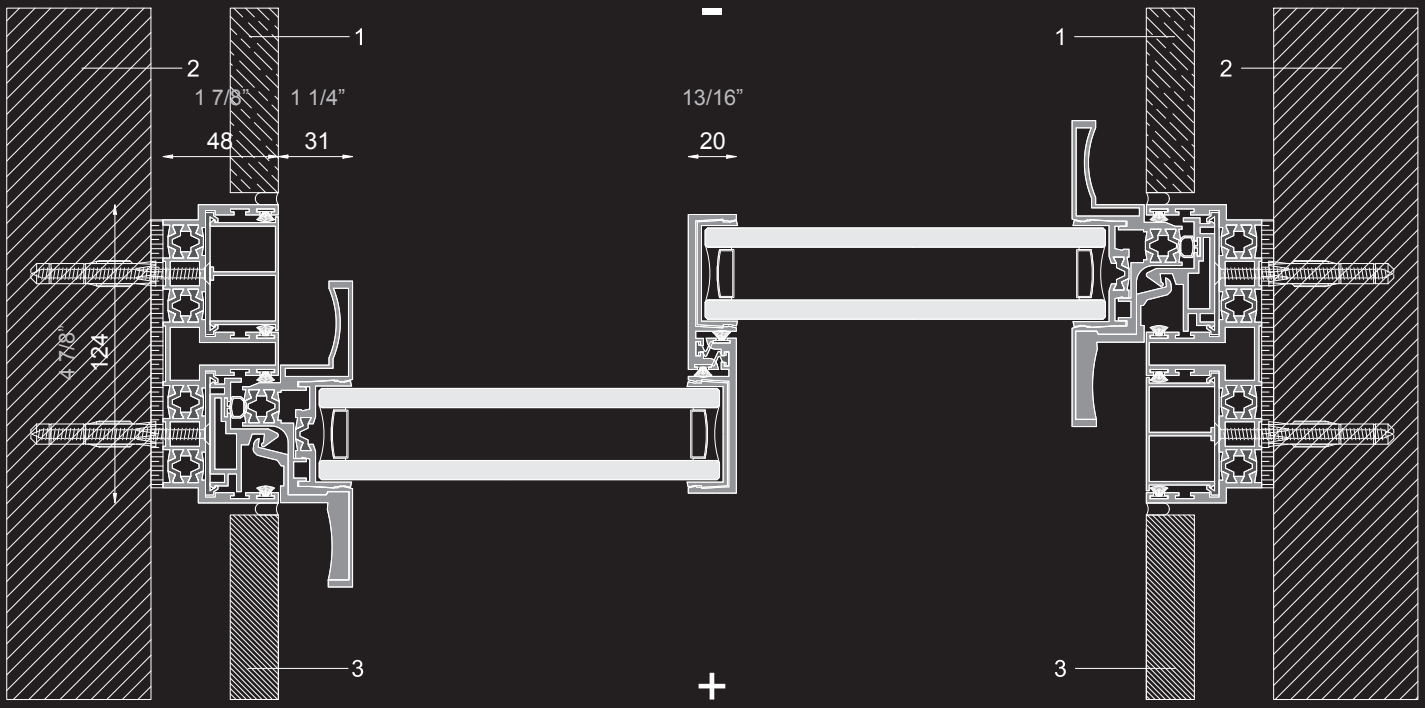

- exterior
- + interior
- 1 external finishing
- 2 structure
- 3 internal finishing
- 4 waterproofing

$4\frac{7}{8}$ "



**OTIIMA PLUS**



GERMAN  
DESIGN  
AWARD  
WINNER  
2019



reddot award 2017  
winner

OTIIMA PLUS is the evolution of the minimal frame systems. Designed from extensive knowledge and experience, it represents the most sophisticated version of a flushed frame, ensuring high performance and a uniform aesthetic across the window providing a seamless transition between interior and exterior.

It has received multiple design awards, recognizing its exceptional air and water performance in the market. In addition to its aesthetic design, it excels in air permeability, wind load resistance, and overall stability.

The PLUS system is available in 26mm glass featuring insulated glass or non-insulated monolithic glass panels, in 38mm insulated glass, ideal for warm to moderately colder climates and 54mm, with triple-pane insulated glass panels specifically designed for colder climates, noise reduction and impact performance.

# Best performance in the market

## Performance up to

<b>Watertightness</b> ISO EN 12208 + ISO EN 1027	<b>E1200 (54mm)</b> (4 classes above 9A) *1
<b>Air Permeability</b> ISO EN 12207 + ISO EN 1026	<b>Class 4</b> (600 Pa or 119 Km/h) *1 *2
<b>Wind Resistance</b> ISO EN 12210 + ISO EN 12211	<b>Class C5</b> (in 6 possible classes) *2
<b>Impact Resistance</b> ISO EN 12600 + ISO EN 1630	<b>Class 5</b> (2000 Pa or 200 Km/h)
<b>Acoustic Insulation</b> ISO EN 10140 + ISO EN 717	<b>Rw: 42 db (up to)</b>
<b>Security</b> ISO EN 1628 + ISO EN 1629 + ISO EN 1630	<b>RC2: (WK2) *3</b>
<b>Calculation Mododule 4.60 x 3.00 to Thermal Transmittance</b> ISO EN 10077-1 + ISO EN 10077-2 (up to)	
<b>Thermal Transmittance (38mm)</b> Uw Ug = 1,0	<b>up to</b> Uw 1.58 W / m2 K
<b>Thermal Transmittance (54mm)</b> Uw Ug = 0.5	<b>up to</b> Uw 1.07 W / m2 K

## Glass Thickness

<b>A</b>	26 mm
<b>B</b>	38 mm
<b>C</b>	54 mm

## Glass Type

<b>A</b>	Double Glass
<b>B</b>	Triple Glass

## Window Features

● monorail ●● birail ●●● trirail \* customized

<b>horizontal sliding</b> standard	
<b>horizontal sliding</b> corner	

<b>horizontal sliding</b> hidden pocket	
--	--

## Window Customizations

<b>track system</b> visible / hidden bearings	visible
<b>flyscreen</b> retractable opening	●
<b>flyscreen</b> full frame	●
<b>exclusive anti-freeze system</b>	●

<b>locking mechanisms</b> exclusive invisible lock	●
<b>locking mechanisms</b> multiple point lock	●
<b>automation</b>	●

\*1 Plus 54 2415 x 2430 mm  
\*2 Plus 38 2400 x 2290 mm  
\*3 Value reached with hidden lock



All you



NEW

can

see.



VISION

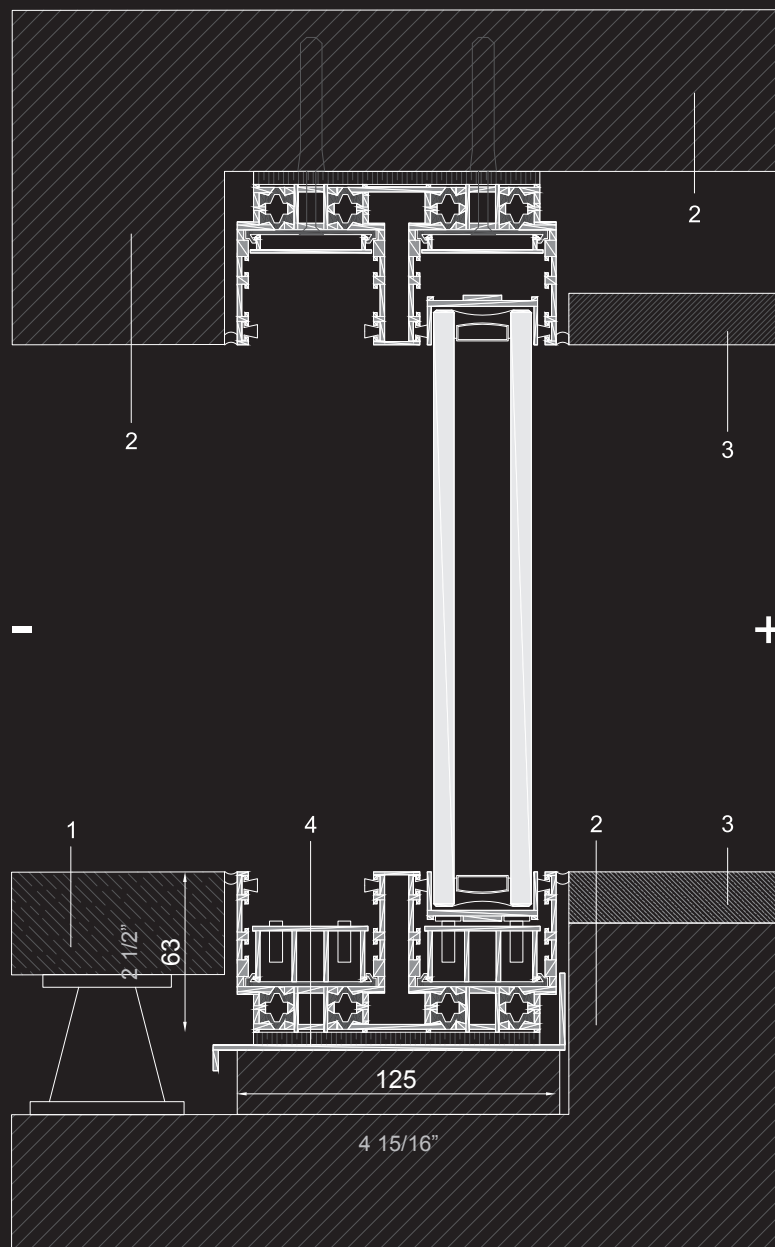
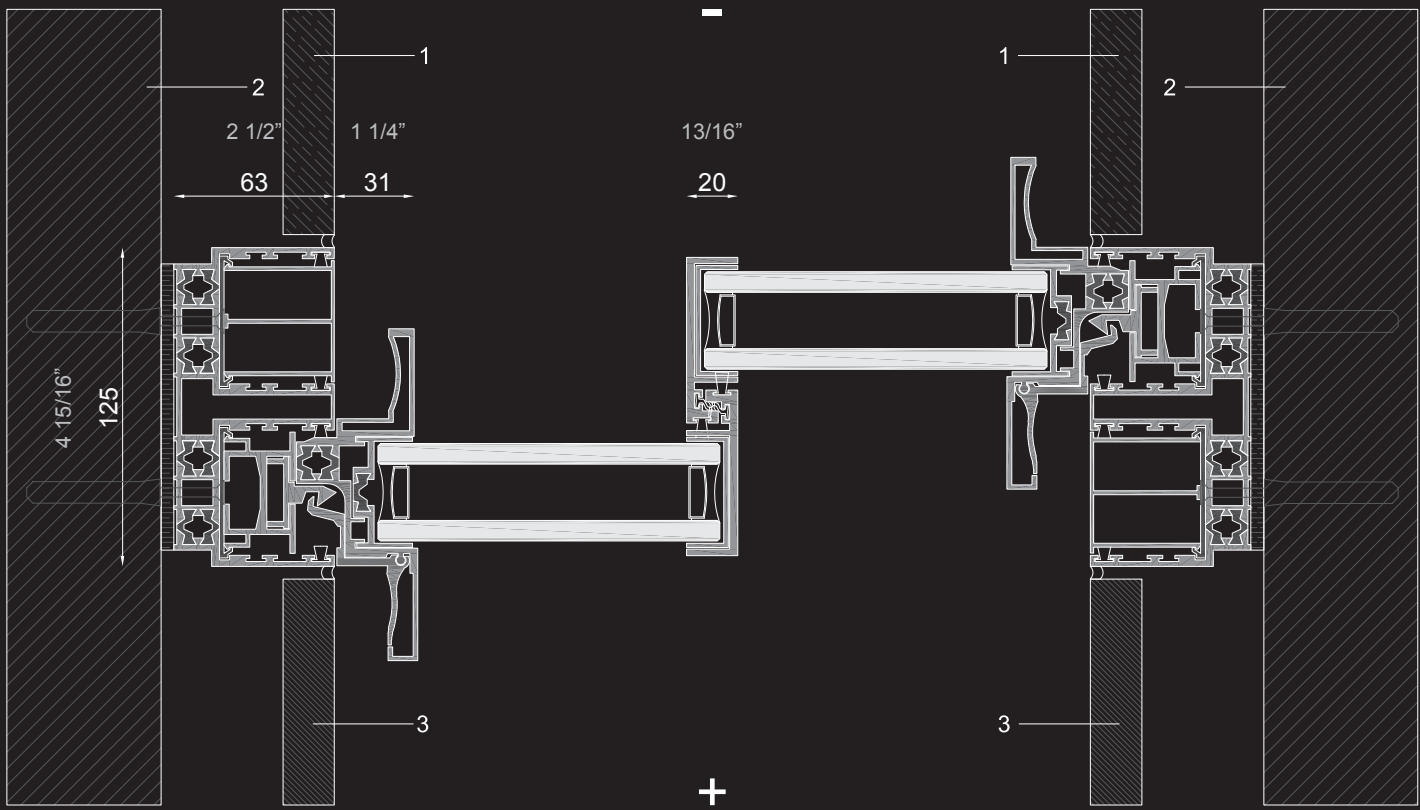

- exterior
- + interior
- 1 external finishing
- 2 structure
- 3 internal finishing
- 4 waterproofing





## NEW VISION

With an outstanding thermal performance and cutting-edge engineering, the **new VISION 62 series** ensures exceptional thermal comfort and optimal energy efficiency.

The VISION system revolutionizes minimalist architectural design by minimizing the visibility of aluminum. VISION conceals the top and bottom rails using slightly expanded recessed outer frames, resulting in superior alignment and a continuous daylight opening.

This design delivers a flush, seamless interface that optimizes natural light penetration while maintaining a commitment to elegance and precision.

VISION system incorporates the 38 Series, the 54 series and the 62 series that combines innovation and engineering to provide a revolutionary solution that elevates architectural design to a new level of efficiency and sophistication.

With an outstanding thermal performance and cutting-edge engineering, the new Vision 62 series ensures exceptional thermal comfort and optimal energy efficiency. An innovative technology provides singular sound insulation for quieter and more comfortable spaces.

Floor-to-ceiling glass integration for a modern and elegant design that maximizes natural light and offers a stunning visual connection to the outdoors.

## Performance up to

<b>Watertightness</b> ISO EN 12208 + ISO EN 1027	<b>E1200</b> (7 classes above 9A) *1
<b>Air Permeability</b> ISO EN 12207 + ISO EN 1026	<b>Class 4</b> (600 Pa or 110 Km/h) *1
<b>Wind Resistance</b> ISO EN 12210 + ISO EN 12211	<b>Class B5</b> (2000 Pa or 200 Km/h) *1
<b>Impact Resistance</b> ISO EN 12600 + ISO EN 1630	<b>Class 5</b>
<b>Acoustic Insulation</b> ISO EN 10140 + ISO EN 717	<b>Rw: 42 db (up to)</b>
<b>Security</b> ISO EN 1628 + ISO EN 1629 + ISO EN 1630	<b>RC2: (WK2) *2</b>
<b>Calculation Mododule 4.60 x 3.00 to Thermal Transmittance</b> ISO EN 10077-1 + ISO EN 10077-2 (up to)	
<b>Thermal Transmittance (38mm)</b> Uw Ug = 1,0	<b>up to</b> Uw 1.56 W / m2 K
<b>Thermal Transmittance (54mm)</b> Uw Ug = 0.5	<b>up to</b> Uw 1.06 W / m2 K

## Glass Thickness

<b>A</b>	38 mm
<b>B</b>	54 mm
<b>C</b>	62 mm

## Glass Type

<b>A</b>	Double Glass
<b>B</b>	Triple Glass

## Window Features

● monorail ●● birail ●●● trirail \* customized

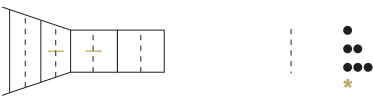
<b>horizontal sliding</b> standard	
<b>horizontal sliding</b> corner	

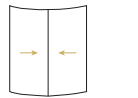
<b>horizontal sliding</b> hidden pocket	
<b>glass features</b> curved	

## Window Customizations

<b>track system</b> visible / hidden bearings	visible
<b>flyscreen</b> full frame	●
<b>exclusive anti-freeze system</b>	●

<b>locking mechanisms</b> exclusive invisible lock	●
<b>locking mechanisms</b> multiple point lock	●
<b>automation</b>	●

\*1 Vision 38 (Option III) - 2860x 2860 mm

\*2 Value reached with hidden lock



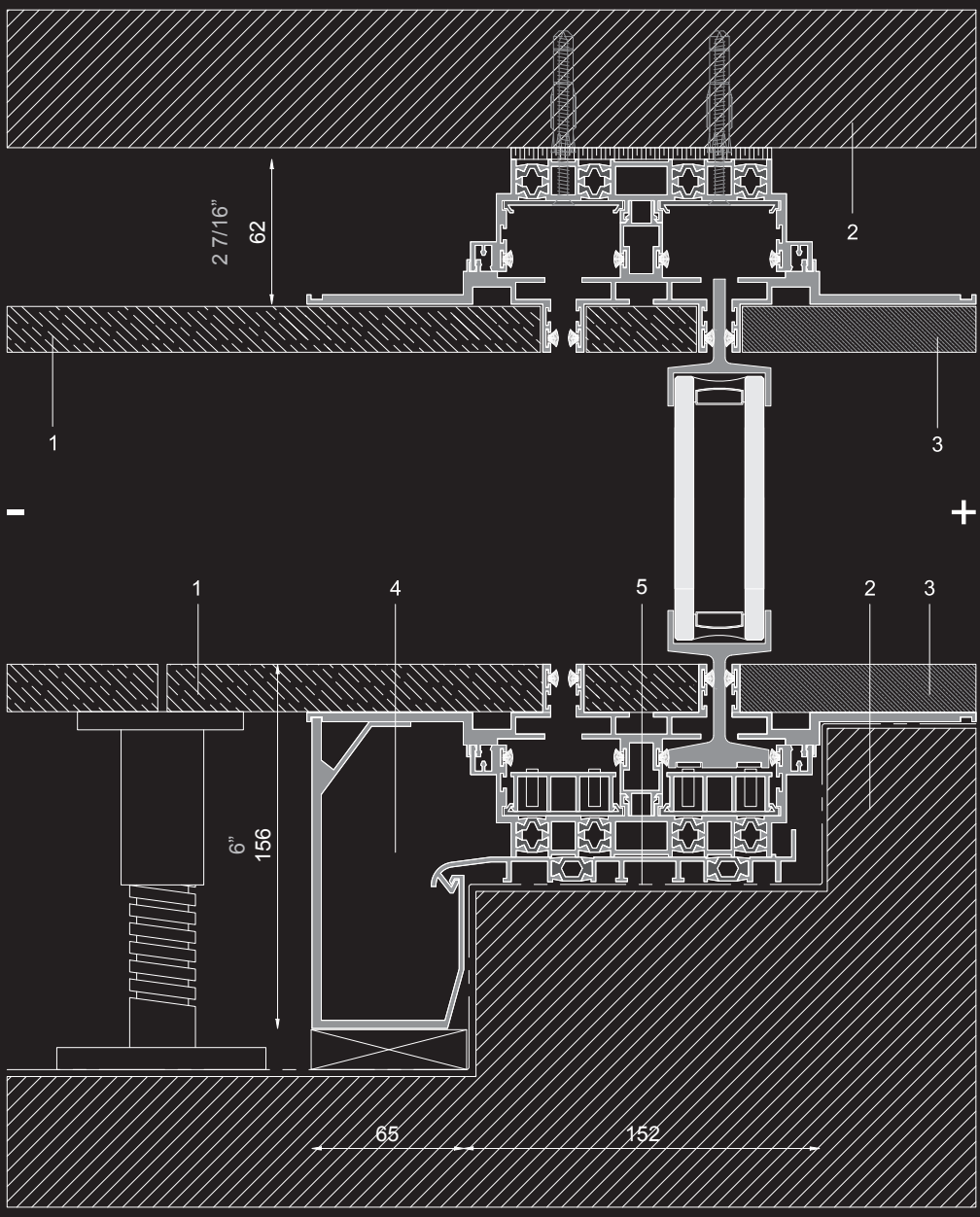
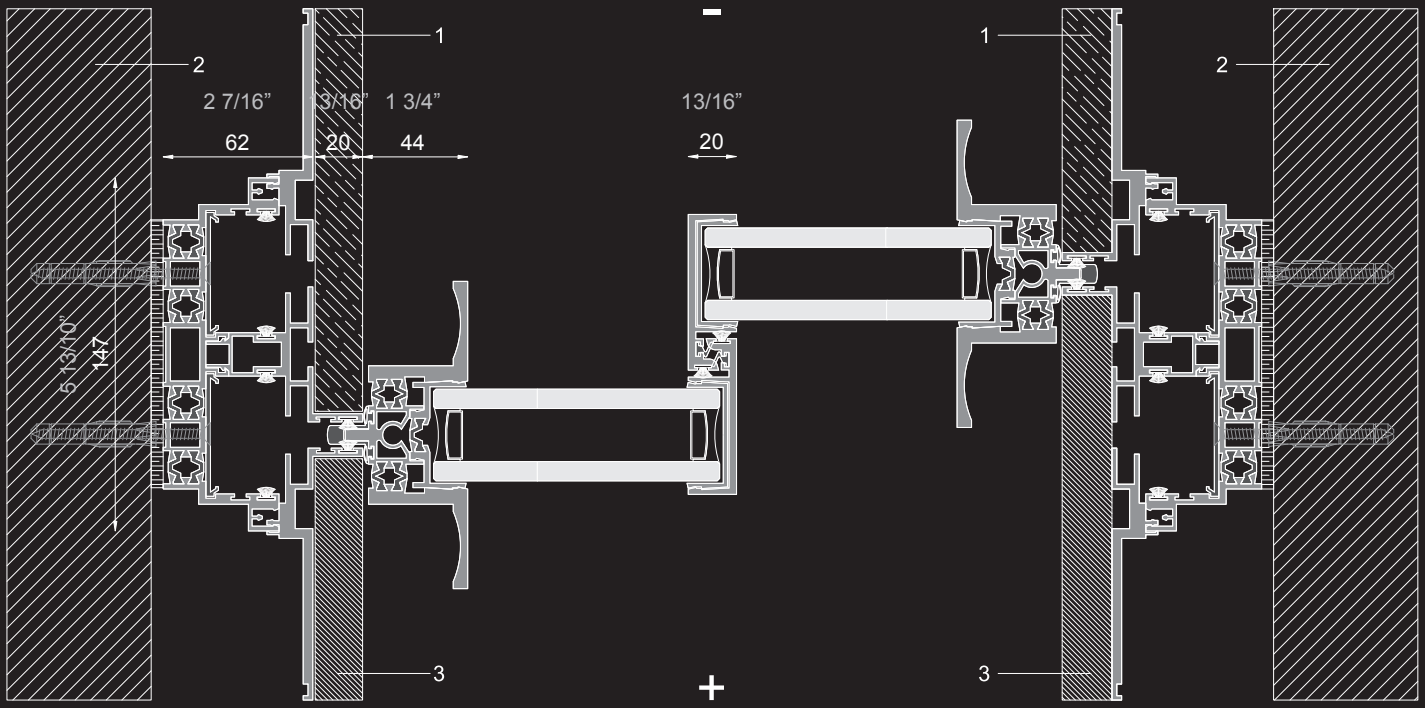

- exterior
- + interior
- 1 external finishing
- 2 structure
- 3 internal finishing
- 4 drainage channel
- 5 waterproofing

$2\frac{9}{16}"$        $6"$



OTIIMA FUSION



OTIIMA FUSION is an advanced system seamlessly integrated into architectural materials. It features a hidden header, sill, and jamb frames. Its minimalistic design gives the illusion of “floating” glass door panels, ensuring superior thermal and structural performance.

The system excels in drainage, effectively managing rainwater even in extreme conditions. It has also achieved exceptional results in leakage tests and is rated E1650 class (7 classes above 9a) per EN + ISO EN 1027.

The FUSION system supports 38mm insulated glass and 54mm that accommodate triple-glazing for higher thermal performance.

## Performance up to

<b>Watertightness</b> ISO EN 12208 + ISO EN 1027	<b>E1650</b> (7 classes above 9A) *1
<b>Air Permeability</b> ISO EN 12207 + ISO EN 1026	<b>Class 4</b> (600 Pa or 110 Km/h) *1
<b>Wind Resistance</b> ISO EN 12210 + ISO EN 12211	<b>Class C5</b> (2000 Pa or 200 Km/h) *1
<b>Impact Resistance</b> ISO EN 12600 + ISO EN 1630	<b>Class 5</b>
<b>Acoustic Insulation</b> ISO EN 10140 + ISO EN 717	<b>Rw: 42 db (up to)</b>
<b>Security</b> ISO EN 1628 + ISO EN 1629 + ISO EN 1630	<b>RC2: (WK2) *2</b>

### Calculation Mododule 4.60 x 3.00 to Thermal Transmittance

ISO EN 10077-1 + ISO EN 10077-2 (up to)

<b>Thermal Transmittance (38mm)</b> Uw Ug = 1,0	<b>up to</b> Uw 1.63 W / m2 K
<b>Thermal Transmittance (54mm)</b> Uw Ug = 0.5	<b>up to</b> Uw 1.29 W / m2 K

## Glass Thickness

<b>A</b>	38 mm
<b>B</b>	54 mm

## Glass Type

<b>A</b>	Double Glass
<b>B</b>	Triple Glass

## Frame options

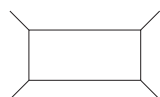

**Fusion**  
Option I

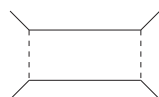

**Fusion**  
Option II

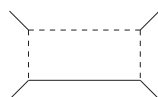

**Fusion**  
Option III

## Window Features

● monorail ●● birail ●●● trirail \* customized

**horizontal sliding**  
standard

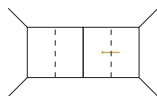

**horizontal sliding**  
hidden pocket

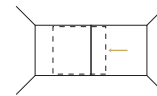

**horizontal sliding**  
corner

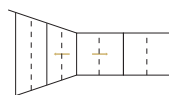

**glass features**  
curved



## Window Customizations

**track system**  
visible / hidden bearings



hidden

**locking mechanisms**  
exclusive invisible lock \*3



**flyscreen**  
full frame



**locking mechanisms**  
multiple point lock \*3



**exclusive anti-freeze system**



**automation**



\*1 Fusion 38 (Option III) - 3020 x 2950 mm

\*2 Value reached with hidden lock on Option II and III.

\*3 Available on Option II and III.



Architecture is the learned game, correct and

**- Le Corbusier**



magnificent, of forms assembled in the light.



MUCH

SOLUTION



A

MORE



architecture AIREA MATEUS project JJ WAREHOUSE image BRUNO LANGA

THAN

Just like the flâneur – that observer of urban life described by Charles Baudelaire – who wandered through the streets of Paris in search of the essence of city life, we, when contemplating the world through the openings of our windows, find a moment of pause, an invitation to reflect, a chance to slow down and observe.

Each glance outward becomes an encounter with time – the sun’s rising and setting, the movement of the clouds, the shadows dancing across buildings, and the life slowly unfolding before our eyes.

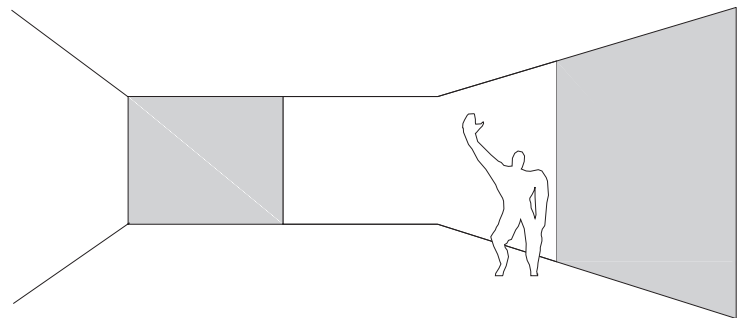
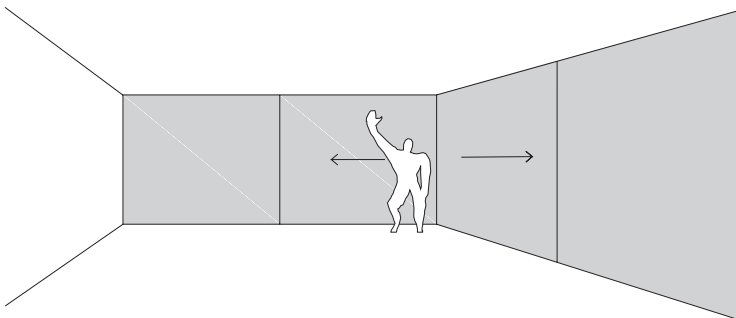
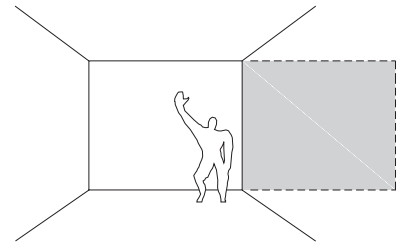
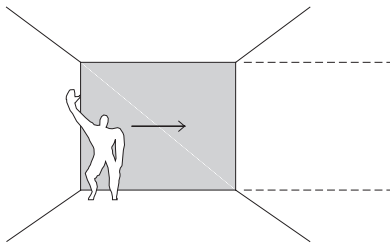
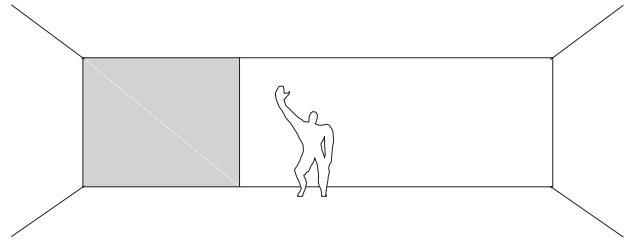
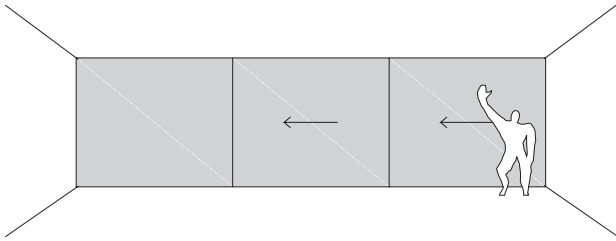
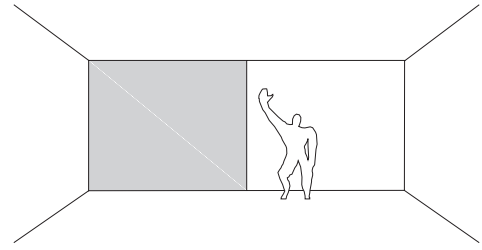
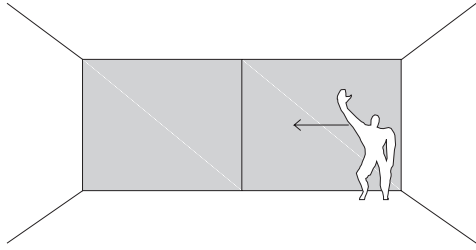

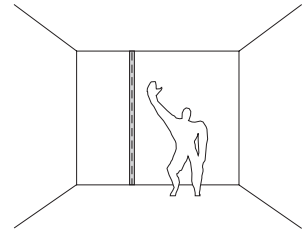
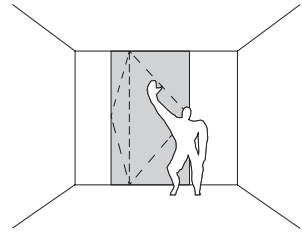
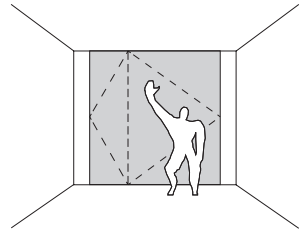
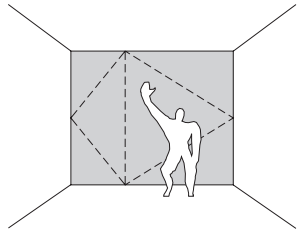
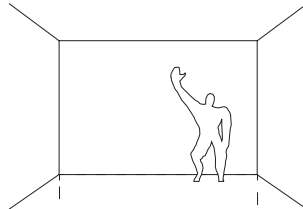
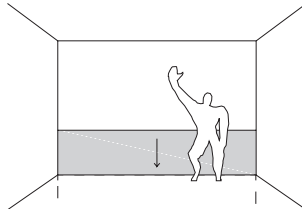
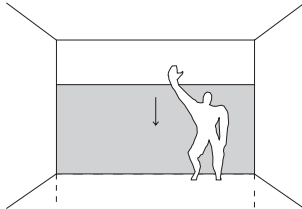
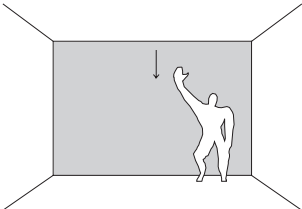
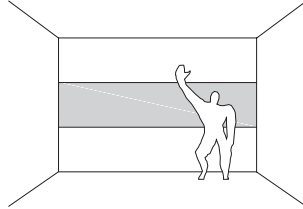
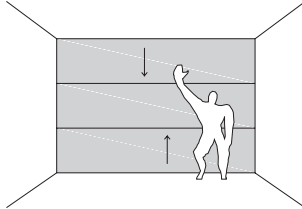
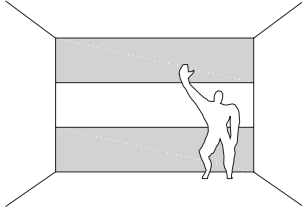
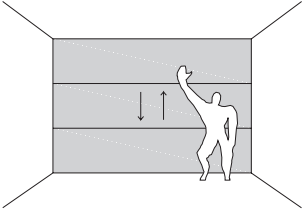

SASH (CENTRAL OPENING)

RETRACTABLE

PIVOT

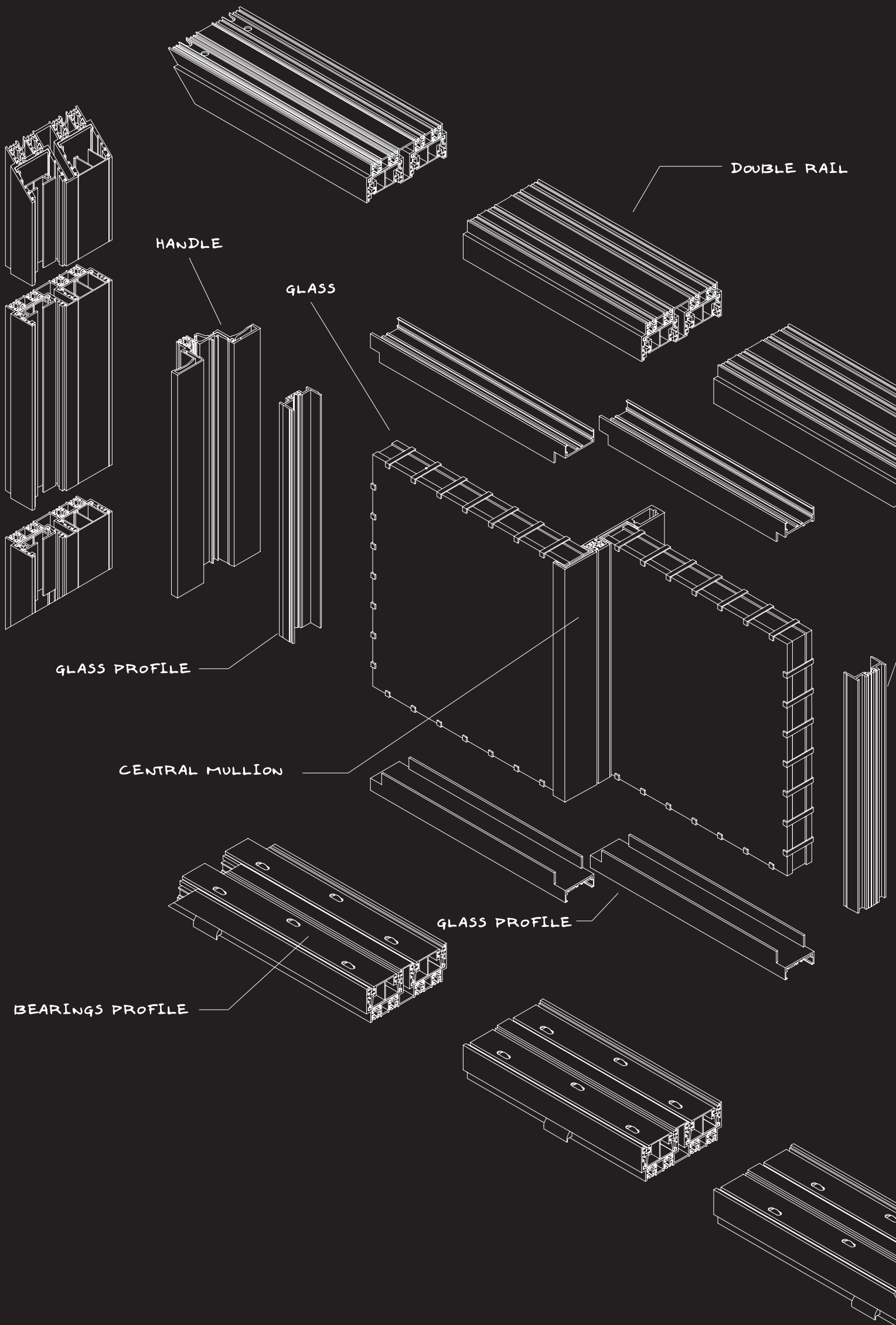



## the anatomy of a minimalist window

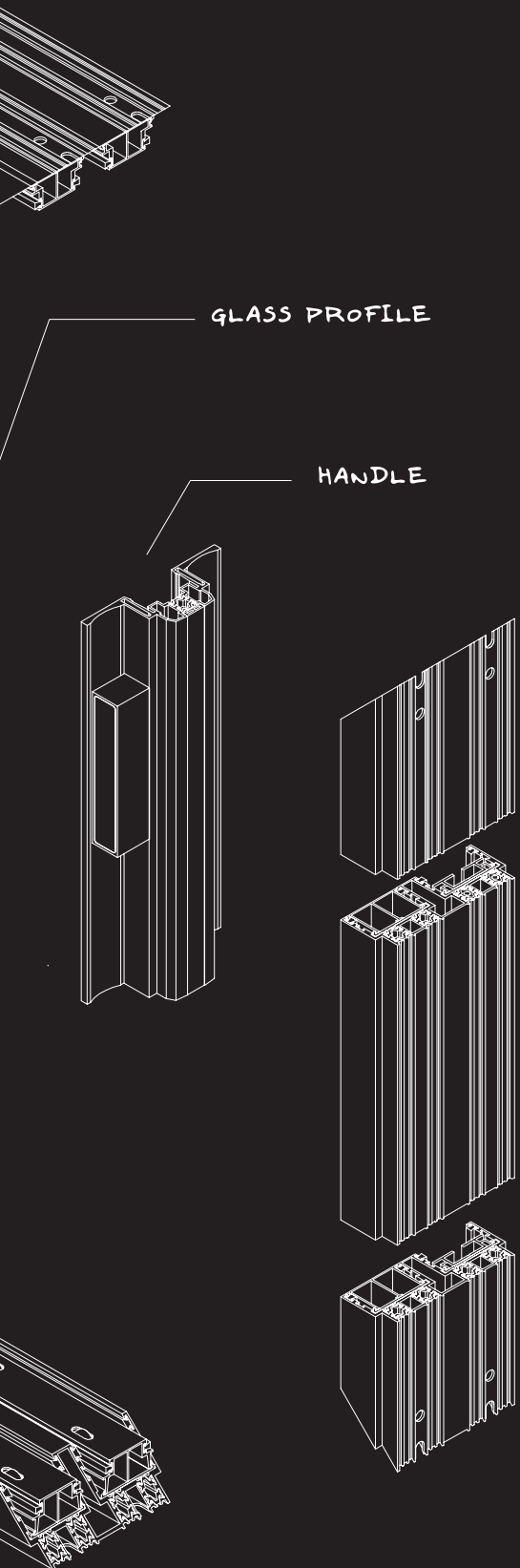

Minimalism, a defining characteristic of OTIIMA, is a pursuit of purity and elegance, where the essential is emphasized, minimalism is in the details, and the unnecessary is gracefully removed. More than a way of life, minimalism is a philosophy that influences every aspect of design—from architecture to interiors and the objects that shape our environments. By concentrating on what truly matters, OTIIMA's minimalism crafts spaces and products that are visually captivating and functionally flawless.

Its charm lies in the ability to design and transform the ordinary into something remarkable, using only a few elements, yet every detail becomes essential with such refinement. This timeless approach transcends fleeting trends, cultivating tranquility, sophistication, and balanced atmospheres. At OTIIMA, minimalism embodies the continuous pursuit of innovation and perfection, where simplicity seamlessly merges with refined architecture and cutting-edge design, continually setting new standards in the industry.

# MOTORIZED SLIDING SYSTEM

special solution



**Project by**  
OTIIMA

**Year**  
2018

**Photography**  
OTIIMA

**System**  
Plus 38

The OTIIMA Automatic Sliding Windows represents an effortless system whose main priorities are comfort, safety, and usability. The stainless-steel frame of the motor reflects the highest quality standards and the attention that OTIIMA gives to each detail. The self-lubricating polymer compound is maintenance-free, ensures longevity, and avoids the probability of firsts, highlighting the smoothness of the window sliding. OTIIMA manufacturing can offer various designs for motor placement while maintaining the same high performance.

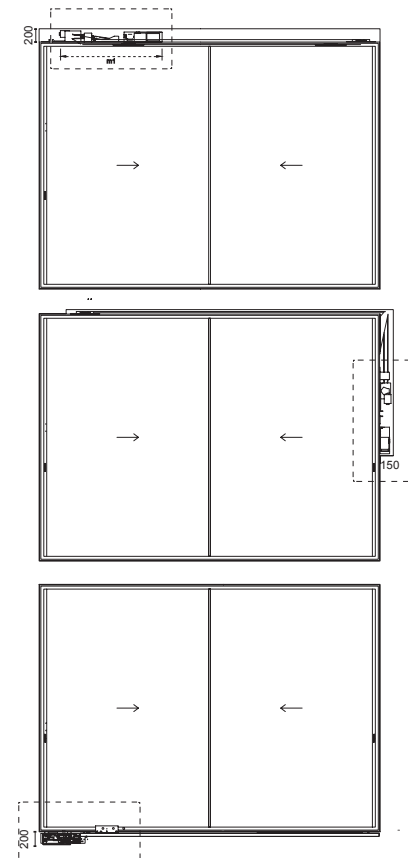

# MOTORIZED GUILLOTINE SYSTEM

special solution



**Project by**  
OTIIMA

**Year**  
2022

**Photography**  
João Rey Soares

**System**  
Classic 38

With a sleek design, the OTIIMA motorized guillotine system provides limitless custom-made versions with high-precision counterweight operation. The refinement lies in the homogenous design and configuration of the structural system with hidden counterweights and pulleys, balancing the mass of operable panels.

The flawless movement to the eye captures and preserves the minimalist character of OTIIMA, while in the back scene, thousands of "theater technicians" help create the fantastic effect for an exquisite live performance of ascending or descending panels.

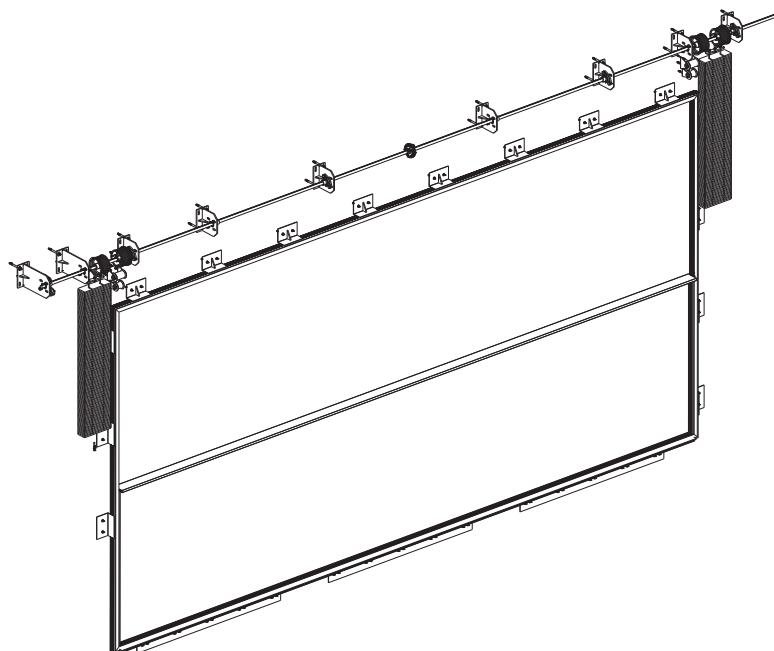

# MOTORIZED SLIDING SKYLIGHTS

special solution



**Project by**  
OTIIMA

**Year**  
2020

**Photography**  
Fernando Guerra | FG + SG

**System**  
Skylight 38

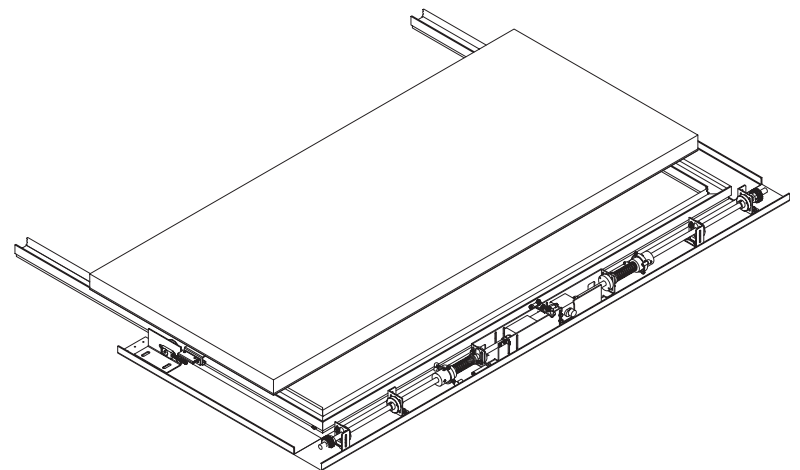

OTIIMA motorized skylights are designed to allow natural light to enter while adding a little extra in terms of design and aesthetics. Structural glazing provides for the expansion of the landscape and the application of large panels with high thermal, wind, and air performance. OTIIMA's customization capabilities provide customers with a unique and personalized version of our products, as in the Náutico Building, a project by Rebelo de Andrade, where the leading role was not only to allow light to enter but also to improve the transition from the ground floor to an upper compartment, as when climbing the main deck of a ship.

# MOTORIZED PIVOT SYSTEM

special solution



**Project by**  
OTIIMA

**Year**  
2021

**Photography**  
João Ferrand

**System**  
Pivot 38

OTIIMA motorized pivot systems enhance stunning looks and contemporary style in every space. The imperceptible motors are integrated into the pivot hinge on the top and bottom side of the door, allowing it to rotate on the vertical axis effortlessly. In terms of functionality and aesthetics, there is an absolute combination: the hands-free pivot door is suitable for countless types of placements in both interior and exterior situations, and there are no limitations. This system adds extra attention to safety thanks to the self-closing function, in an elegant, smooth motion to its closed position after being opened.

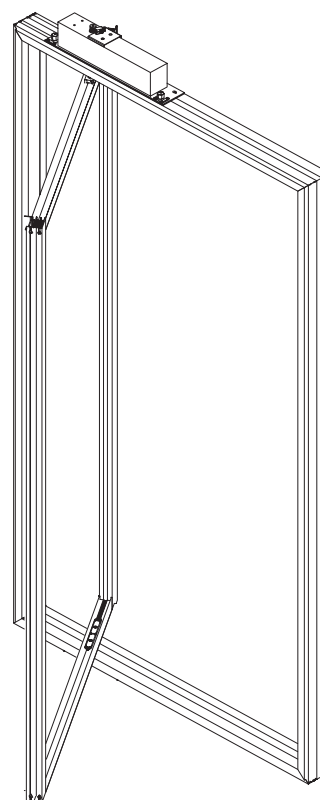

# OTIIMA PIVOT

special solution



**Project by**  
OTIIMA

**Year**  
2020

**Photography**  
Hervé Abbadie

**System**  
Pivot 38

The OTIIMA PIVOT system enhances stunning looks and contemporary style in every space. It offers clients a broader range of operable door types, often used as entry doors or in a wall of doors. Multiple laminated glass options are available when noise reduction and impact performance are desired.

38 PIVOT uses 38mm (1-1/2") insulated glass and can accommodate oversized "jumbo" double-pane glass.

54 PIVOT uses 54mm (2-1/8") insulated glass and can accommodate oversized "jumbo" double or triple-pane glass.

Available configurations include single and multi-panel, inward/outward opening, and manually operated or automated pivot doors. Each door type can be mullied to fixed windows or window walls for facade applications.

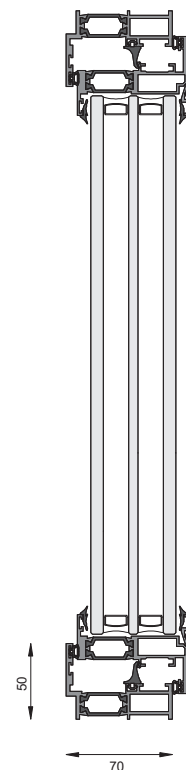

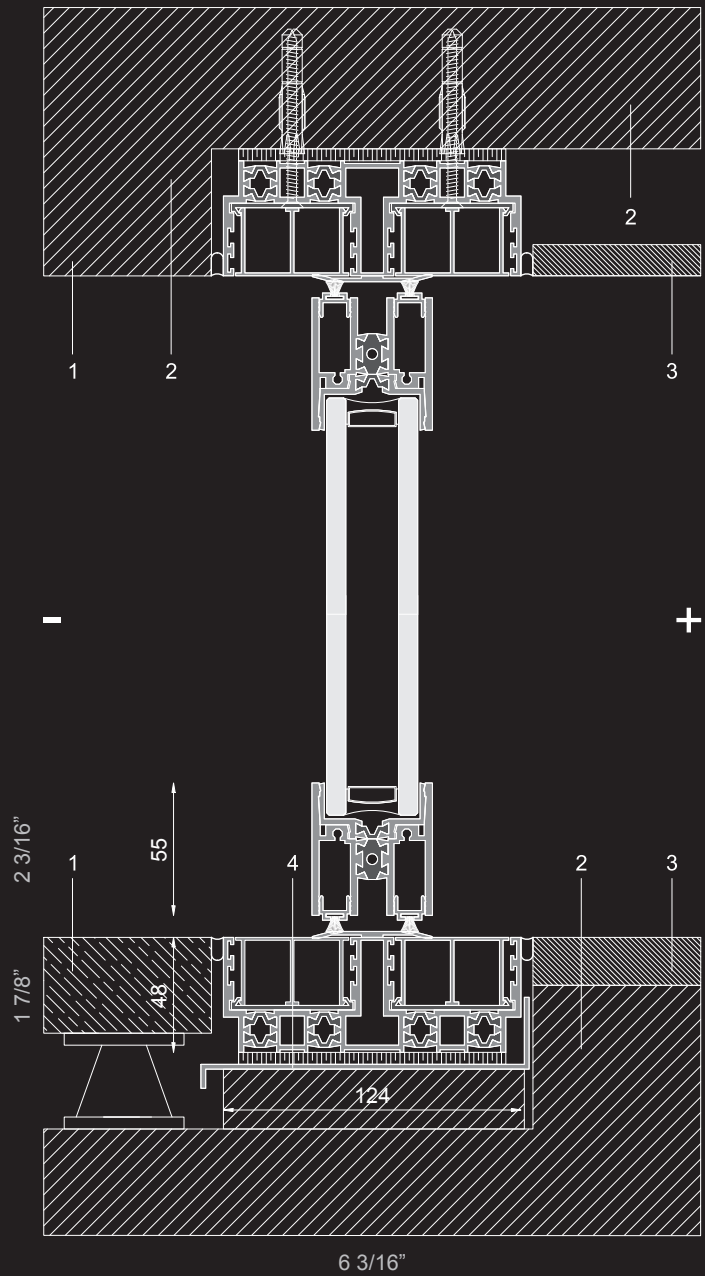
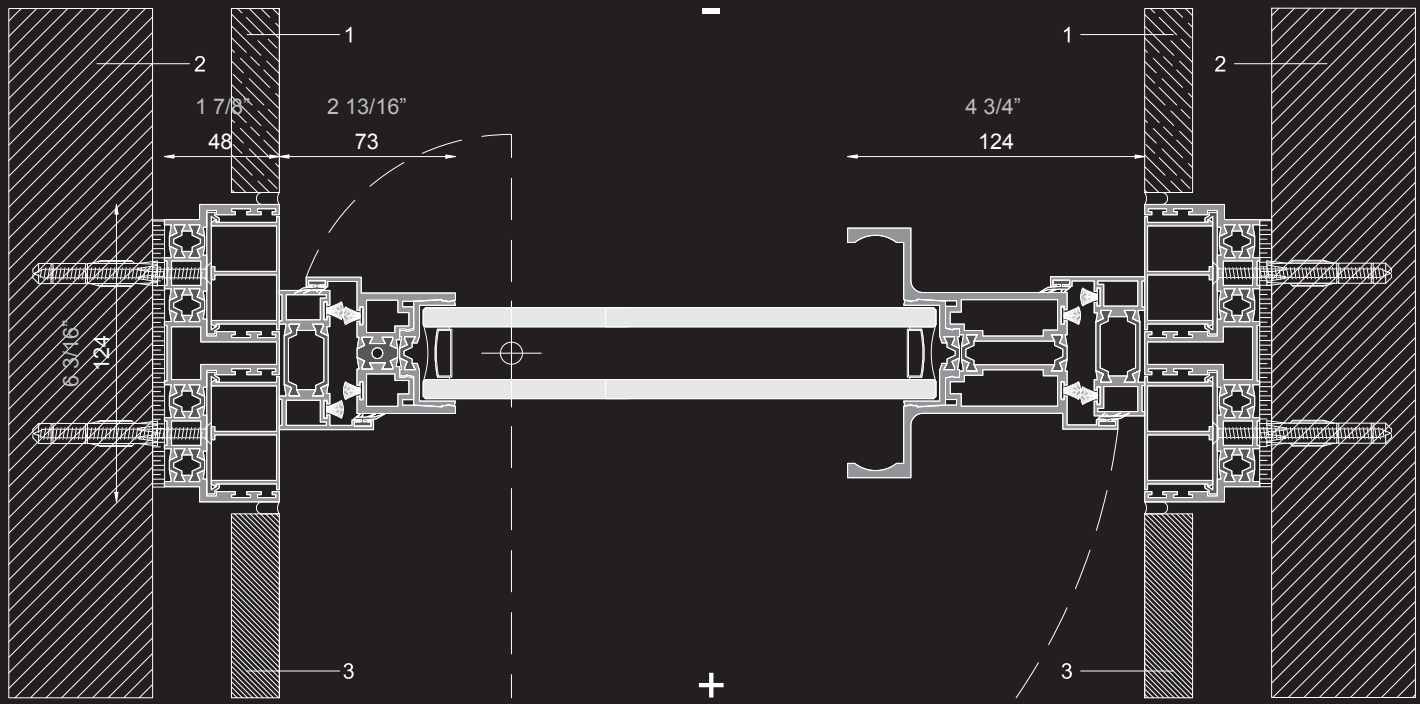

- exterior
- + interior
- 1 external finishing
- 2 structure
- 3 internal finishing
- 4 waterproofing

# INVISIBLE LOCK

special solution



**Project by**  
OTIIMA

**Year**  
2021

**Photography**  
João Ferrand

**Solution**  
Invisible Lock

One of OTIIMA's patented innovations is the INVISIBLE SIDE LOCK, which is integrated into the handle with a subtle design that makes it nearly undetectable. The locks have been tested to meet RC2 security standards for optimal safety and access control.

OTIIMA systems can also incorporate an electromagnetic lock, and the latest generation of OTIIMA solutions allows for seamless integration of alarm systems.

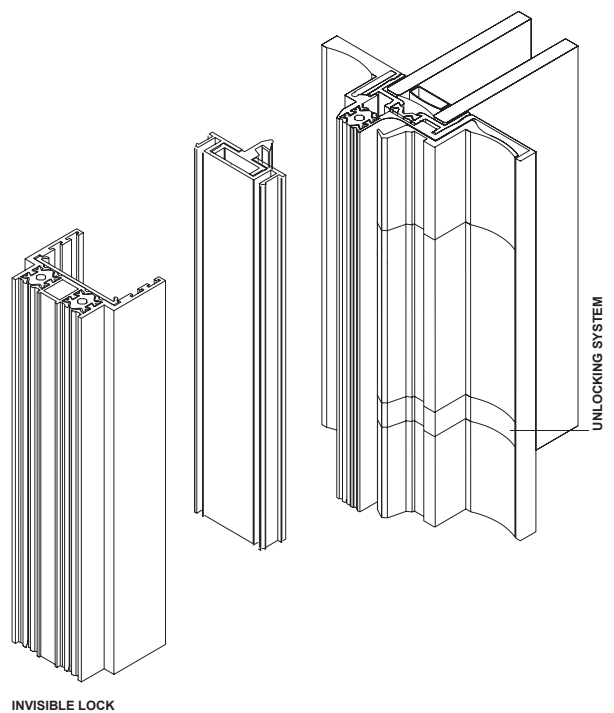



# MEYER LOCK

special solution



**Project by**  
OTIIMA

**Year**  
2019

**Photography**  
Bruno Langa

**Solution**  
Meyer Lock

The HORIZONTAL MEYER LOCK is designed for seamless integration with central covers, combining functionality with elegance. Its discreet and refined design is crafted exclusively by OTIIMA and made entirely of high-quality aluminum. This lock offers both durability and sophistication, enhancing our minimalist solutions.

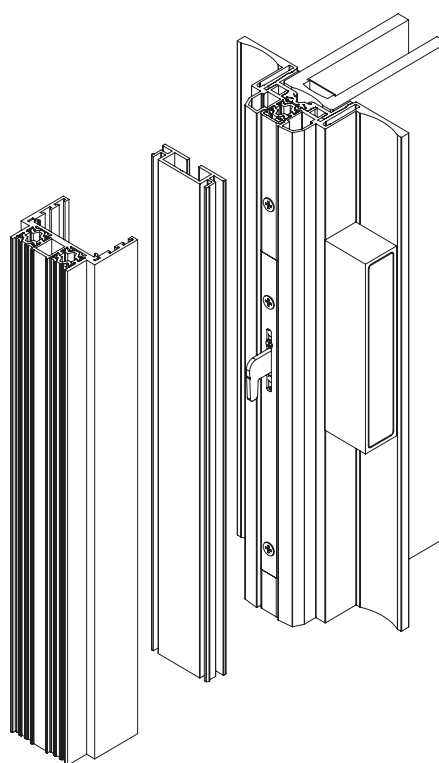

# CURVED GLASS

special solution



**Project by**  
OTIIMA

**Year**  
2021

**Photography**  
OTIIMA

**Solution**  
Plus 38

OTIIMA's custom-made curved frame system brings an aesthetic appeal to the windows and the whole space's architecture. They are engineered accurately to present new possibilities for breathtaking visual effects in every project. The tailored windows can accommodate a sliding or fixed unit according to the project requirements. The beautifully curved panels create a stunning architectural statement to any building, from basements to doors, showcasing the surroundings.

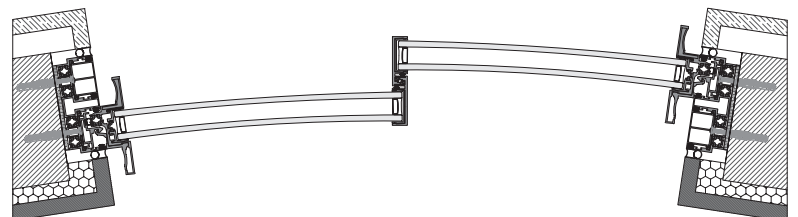

# SLOPED SYSTEM

special solution



**Project by**  
OTIIMA

**Year**  
2019

**Photography**  
OTIIMA

**Solution**  
Sloped Solution

OTIIMA minimalist sloped system is the perfect solution for diagonally sliding windows.

The clean lines of the sloped system provide an accurate perception of the effect of gravity.

The toughened glass allows matchless resistance for large-glazed panels, while the minimalist framing allows seamless integration in the floor, ceiling, and walls, ensuring complete transparency between interior and exterior. The sloped system is ideal for sloping roofs or various other architectural applications.

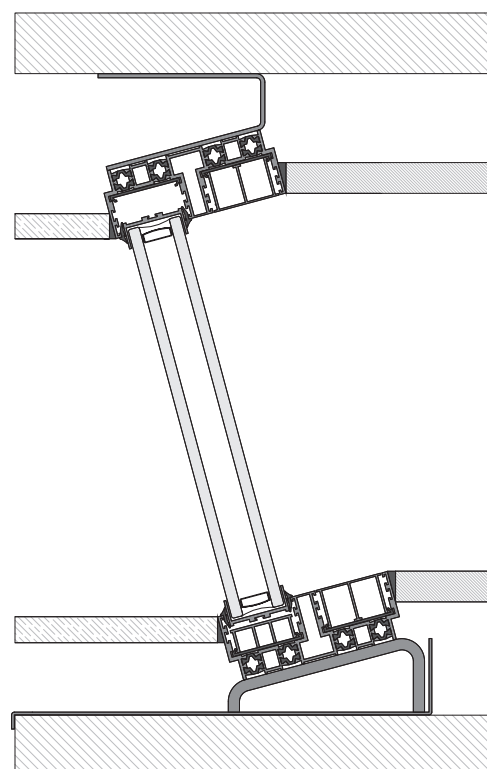

# the language of emotion

## Do the Right Thing, Do It with Style

The OTIIMA Colors Palette was created to transform every project into a masterpiece, blending style, sophistication, and personality. From vibrant shades to delicate tones, this exclusive collection showcases a luxurious deep-textured finish, ensuring timeless, durable, and captivating timeless beauty.

At OTIIMA, every project tells a unique story. That's why our color palette is designed with remarkable versatility, adapting flawlessly to the needs and character of each space. Whether for elegant interiors or striking exteriors, the palette's flexibility allows for impeccable customization, bringing each client's vision to life with elegance and precision.

## POWDER COATING FINISHES

**Because style isn't just a choice—it's a statement.**



**OT10A**  
BREEZE

**OT11**  
RICH SAND

**OT13A**  
ROYAL BROWN

**OT14**  
CHARCOAL

**OT15**  
DESERT SAND

**OT16**  
ROYAL GOLD

**OT19A**  
NOIR

**OT21**  
BLACK





## the revolution of minimalism with OTIIMA

Aesthetic simplicity is a philosophy and approach that focuses on the essentials, eliminating the superfluous to achieve clarity, purpose, and harmony. This perspective translates into intentional creation, prioritizing functionality and timeless beauty in design, architecture, and life. It's about valuing what truly matters, shedding excess, and celebrating the connection between form and function.

OTIIMA, a renowned brand in minimalist window systems, embodies this philosophy at its core. Its architectural solutions go beyond the traditional concept of openings, transforming them into portals that connect interiors to the outside world without visual or conceptual barriers. The company emphasizes using innovative materials and cutting-edge technology to create minimalist solutions that respect space, light, and landscape, perfectly aligning with this worldview safety standards and reflects a deep respect for nature, contemporary design, and functionality.



**OTIIMA Headquarters**

Parque Industrial de Laúndos, Lote 40  
4570-311 Laúndos - Portugal  
+351 252 219 952

**[info@otiima.com](mailto:info@otiima.com)**

**[www.otiima.com](http://www.otiima.com)**

MUCH  
MORE  
THAN A  
WINDOW